

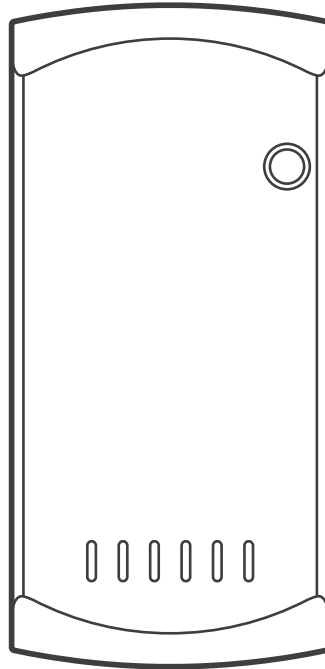

iFan04

User manual V1.2



Wi-Fi Smart Ceiling Fan with Light Controller

产品介绍

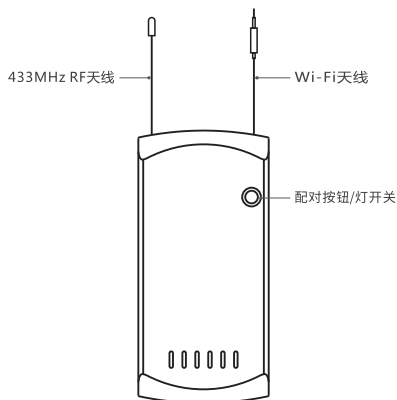

⚠ 设备重量 < 1kg, 建议安装高度 < 2米。

产品特点

本设备为一款风扇灯控制器, 风扇灯通过与本设备相连可在易微联App 端分别控制灯、风扇的开关, 风速控制、设置定时开/关和分享给您的家人一起控制等等。



远程控制



智能定时/延时



语音控制



分享功能



风速控制



智能场景



同步状态



433MHz 遥控控制



局域网控制



创建群组

使用说明

1. 断电

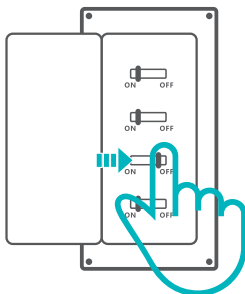

⚠ 设备安装、故障维修请由专业资质电工操作。切勿在设备通电时进行接线操作或触碰到接线端子, 以免发生触电危险!

2. 接线

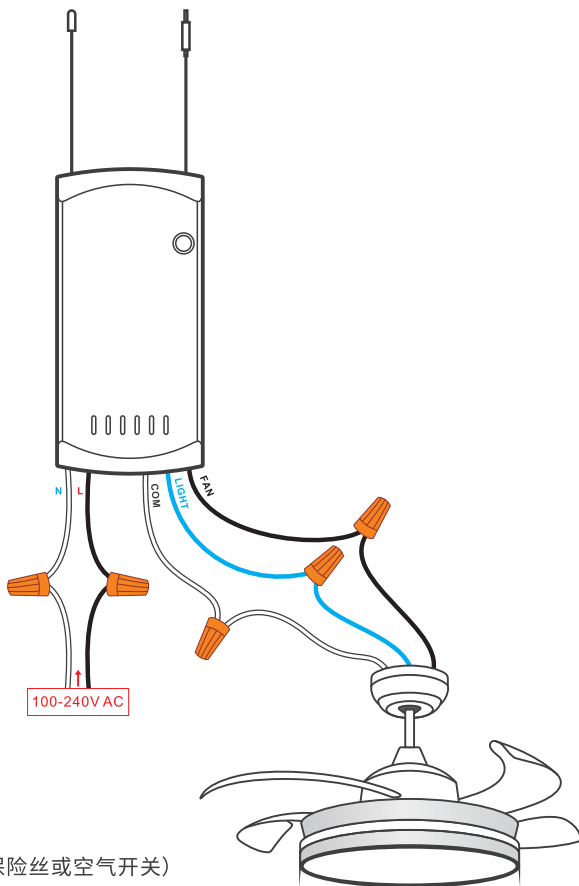

⚠ L 端输入前需接保护装置 (如: 保险丝或空气开关)

⚠ 确保线接入无误。

⚠ 为确保电气安装的安全, 必须在 iFan04-L, iFan04-H 前面安装符合国家安全标准额定电流为 5A 的微型断路器 (MCB) 或漏电保护断路器 (RCBO)。

3. 设备安装

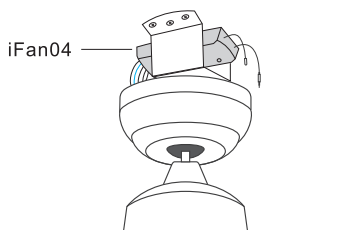

>

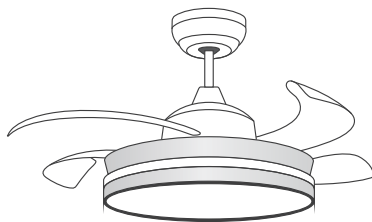

4. 下载“易微联”App

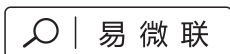

Android™ & iOS

5. 上电

通电后,设备首次使用,默认进入快速配网模式。设备蜂鸣器呈两短一长响声。

Ⓢ 三分钟内没有进行配网,设备将退出快速模式。如需再次进入,长按设备配对按钮5秒或将设备连续上电3次(开-关-开-关-开)直到设备蜂鸣器呈两短一长响声即可。

6. 添加设备

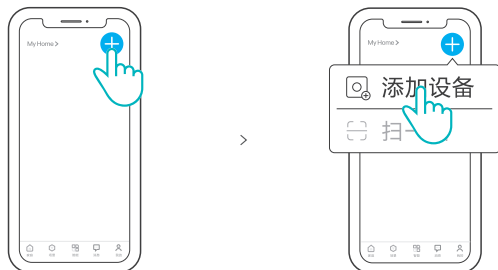

点击“+”,选择“添加设备”,再根据App提示进行操作。

兼容配网模式

如使用快速添加模式配网失败,请使用“兼容配网模式”进行配对。

① 长按设备配对按钮5秒直到设备蜂鸣器呈“两短一长”响声,松开。再次长按配对按钮5秒直到设备蜂鸣呈“快响”状态(滴滴滴滴.....),此时设备进入兼容配网模式。

② 在app界面,点击“+”选择“添加设备”,再选择“兼容模式”。

先把移动设备连接上Wi-Fi账号为:ITEAD-*****,密码为:12345678,然后回到“易微联”app,点击“下一步”,等待配对完成。

Ⓢ 设备连续上电5次(开-关-开-关-开-关-开-关-开)也可进入“兼容配网模式”

取出遥控器绝缘片

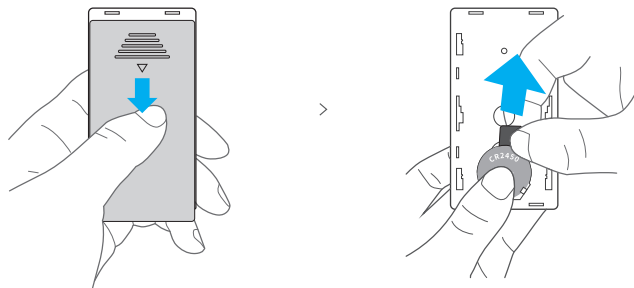

出厂时, RM433R2遥控器已与 iFan04 进行绑定, 取出遥控器电池绝缘片之后即可进行控制, 如不能控制, 请尝试重新学习。

设备与RM433R2遥控器的学习方法:

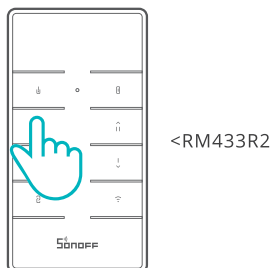

在设备上电后的5秒内长按遥控器任意按键至设备蜂鸣器“滴”一声, 即全部按键学习成功, 如5秒内未进行下一步操作, 请重新上电。

⚠ 设备最多配对10遥控器, 超过10个则会自动覆盖第一个学习的遥控器, 以此类推。

产品参数

型号	iFan04-L, iFan04-H
输入	100-240V~ 50/60Hz 5A Max
输出	<p>iFan04-L: 灯具: 100-240V~ 50/60Hz 3A Max 钨丝灯: 360W/120V Max LED: 150W/120V Max 风扇: 100-240V~ 50/60Hz 2A Max</p> <p>iFan04-H: 灯具: 100-240V~ 50/60Hz 3A Max 钨丝灯: 690W/230V Max LED: 300W/230V Max 风扇: 100-240V~ 50/60Hz 2A Max</p>
RF	433.92MHz(仅接收)
Wi-Fi	IEEE 802.11 b/g/n 2.4GHz
App 支持系统	Android & iOS
工作温度	-10°C~40°C
外壳材料	PC V0
产品规格	116x55x26mm

更换设备网络

在 eWeLink App 设备设置界面选择“WiFi设置”进行更换。

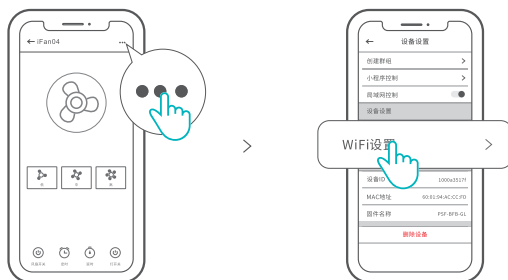

重新配对

方法1:

长按设备“配对按钮”5秒直到设备蜂鸣器呈两短一长响声, 松开, 此时设备进入快速配网模式, 即可再次通过 eWeLink App 进行添加。

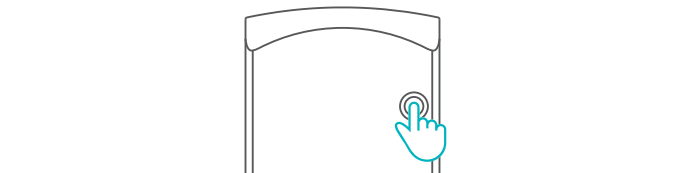

方法2:

长按RM433R2遥控器配对按钮 5秒直到设备蜂鸣器呈两短一长响声, 松开, 此时设备进入快速配网模式, 即可再次通过 eWeLink App 进行添加。



方法3:

将设备连续上电3次(开-关-开-关-开),直到设备蜂鸣器呈两短一长响声, 松开, 此时设备进入快速配网模式, 即可再次通过 eWeLink App 进行添加。

⚠ 配网模式下, 短按遥控器任意按键可退出当前模式。

恢复出厂设置

在 eWeLink App 端“删除设备”, 设备即恢复出厂设置。

遥控器参数

型号	RM433R2
RF	433.92MHz
遥控器尺寸	87x45x12mm
遥控器底座尺寸	86x86x15mm(可选)
供电	3V纽扣电池 x 1 (电池型号:CR2450)
外壳材料	PC V0

遥控器介绍

iFan04支持使用RM433R2遥控器进行控制,学习成功后,即可根据下图按键说明控制设备,此功能属于本地近程无线遥控与Wi-Fi网络无关。

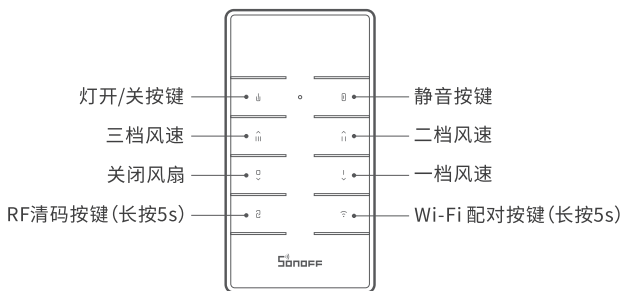

RF清码方法: 长按RF清码按键5秒至设备蜂鸣器发出“滴 滴”两声,即完成清码。

出厂默认设备的蜂鸣器会在开/关风扇、调节风扇档位、设备处于配对模式时发出声音作为操作提示,在开关灯时不会响。如果需要关闭蜂鸣器声音,请通过配对的 433 遥控器短按“静音”按钮关闭。

常见问题

Wi-Fi设备与 eWeLink APP 配对失败。

1. 确保设备处于配对模式。三分钟内没进行配网,设备将自动退出配对模式。
2. 请开启定位服务并允许定位权限。在选择 Wi-Fi 网络之前,请开启定位服务并允许定位权限。位置信息权限用于获取 Wi-Fi 列表信息。如果单击禁用,您将无法添加设备。
3. 确保您的 Wi-Fi 网络为 2.4GHz 频段。
4. 确保您输入了正确的 Wi-Fi SSID 和密码,没有包含特殊字符。密码错误是配对失败的一个非常常见的原因。
5. 配对时设备应靠近路由器,以保证良好的传输信号条件。

执行标准: GB/T 16915.2

产品中有害物质的名称及含量

部件名称	有害物质					
	铅 (Pb)	汞 (Hg)	镉 (Cd)	六价铬 (Cr{VI})	多溴联苯 (PBB)	多溴二苯醚 (PBDE)
塑料件	o	o	o	o	o	o
电子元器件	x	o	o	o	o	o
包装盒	o	o	o	o	o	o
PCB板	o	o	o	o	o	o
五金件	o	o	o	o	o	o

本表格依据SJ/T 11364 的规定编制:

o: 表示该有害物质在该部件所有均质材料中的含量均在GB/T 26572规定的限量要求以下;
x: 表示该有害物质至少在该部件的某一均质材料中的含量超出GB/T 26572规定的限量要求。



注意:

- 本产品含纽扣电池
- 不要吞咽电池, 化学灼伤危险
- 本产品包含纽扣电池。如果吞食纽扣电池, 在2小时内就可能造成严重的内部灼伤并可能导致死亡。
- 让儿童远离新的和使用过的电池
- 如果使用错误型号的电池替换会有着火或者爆炸等安全失效的危险
- 如果电池仓未安全闭合, 停止使用该产品并使之远离儿童
- 如果你认为电池可能已被吞食或放置在身体的任何部位内, 立即寻求医疗救助
- 如果使用错误型号的电池替换会有着火或者爆炸等安全失效的危险
- 将电池投入火中或者加热炉中, 或对电池进行机械挤压或切割处理可能导致爆炸
- 电池放置在极高温环境中, 可能导致爆炸或泄漏可燃液体或气体
- 电池放置在极低气压, 可能导致爆炸或泄漏可燃液体或气体
- 若出现严重膨胀, 切勿继续使用
- 浸水后禁止使用

微功率设备使用说明

(一) 本产品使用的 433MHz 技术符合“微功率短距离无线电发射设备目录和技术要求”中通用无线遥控设备的技术要求,用于数据传输应用。采用一体化天线,控制、调整及开关等使用方法请参考产品说明书中相关内容;

(二) 不得擅自改变使用场景或使用条件、扩大发射频率范围、加大发射功率(包括额外加装射频功率放大器),不得擅自更改发射天线;

(三) 不得对其他合法的无线电台(站)产生有害干扰,也不得提出免受有害干扰保护;

(四) 应当承受辐射射频能量的工业、科学及医疗(ISM)应用设备的干扰或其他合法的无线电台(站)干扰;

(五) 如对其他合法的无线电台(站)产生有害干扰时,应立即停止使用,并采取措施消除干扰后方可继续使用;

(六) 在航空器内和依据法律法规、国家有关规定、标准划设的射电天文台、气象雷达站、卫星地球站(含测控、测距、接收、导航站)等军民用无线电台(站)、机场等的电磁环境保护区域内使用微功率设备,应当遵守电磁环境保护及相关行业主管部门的规定;

(七) 禁止在以机场跑道中心点为圆心、半径5000米的区域内使用各类模型遥控器;

(八) 微功率设备使用温度为-10°C~40°C,供电为3V==

Product Introduction

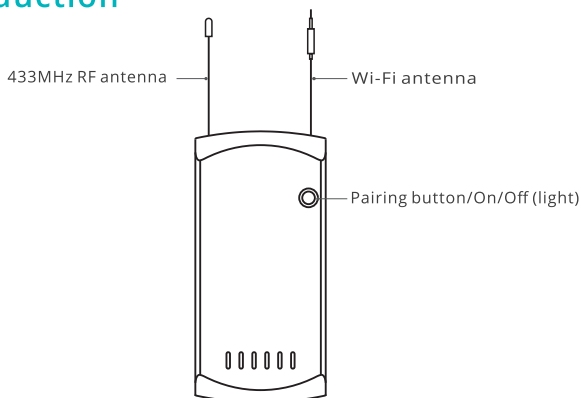

⚠ The device weight is less than 1 kg. The installation height of less than 2 m is recommended.

Features

This is a Wi-Fi smart controller for the ceiling fan with light that allows you to remotely turn on/off the fan and light separately, adjust the fan speed, schedule it on/off and share it with your families to control together, etc. on the eWeLink App.



Remote Control



Single/Countdown
Timing



Voice Control



Share Control



Fan Speed Adjustment



Smart Scene



Sync Status



433MHz Remote
Control



LAN Control



Group Control

Operating Instruction

1. Power off

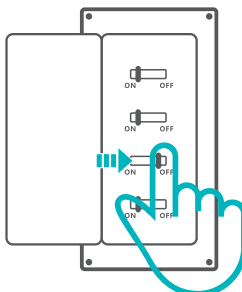

⚠ Please install and maintain the device by a professional electrician. To avoid electric shock hazard, do not operate any connection or contact the terminal connector while the device is powered on!

2. Wiring instruction

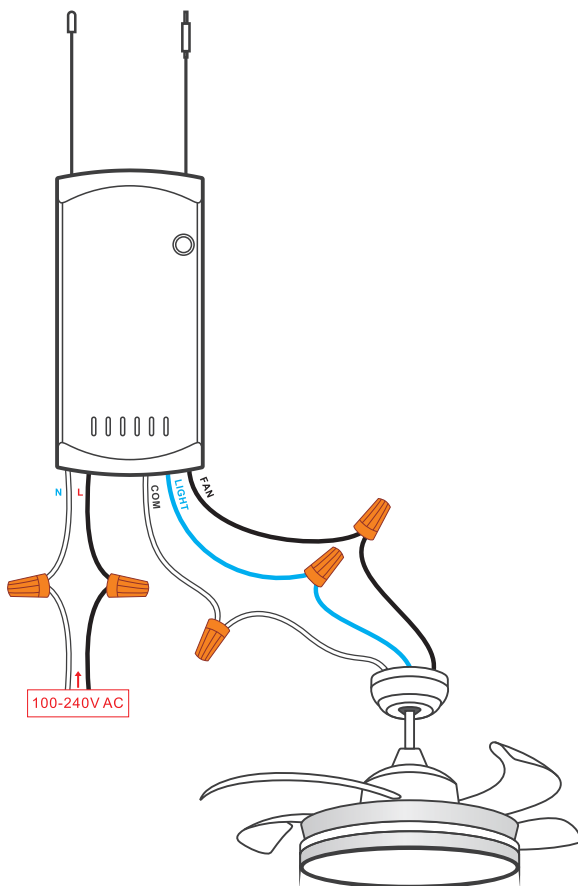

- ⚠ Please install protection devices before connecting the live wire. (e.g. fuses or air switches).
- ⚠ Make sure all wires are connected correctly.
- ⚠ To ensure the safety of your electrical installation, it's essential either a Miniature Circuit Breaker (MCB) or a Residual Current Operated Circuit Breaker (RCBO) with an electrical rating of 5A has been installed before the iFan04-L, iFan04-H.

3. Equipment installation

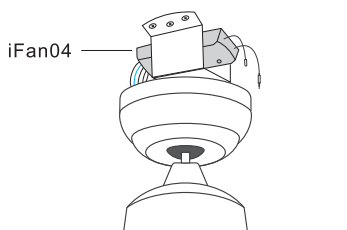

>

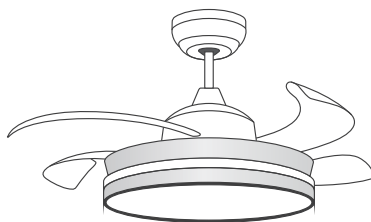

4. Download the eWeLink APP



5. Power on

After powering on, the device will enter the quick pairing mode during the first use, then the device makes two short beeps and one long beep.

- ⓘ The device will exit the quick pairing mode if not be paired within 3mins. If you want to enter the quick pairing mode again, press and hold the pairing button for 5s, or keep turning the device on and off repeatedly for 3 times (on-off-on-off-on) until the buzzer makes two short beeps and one long beep.

6. Add the device

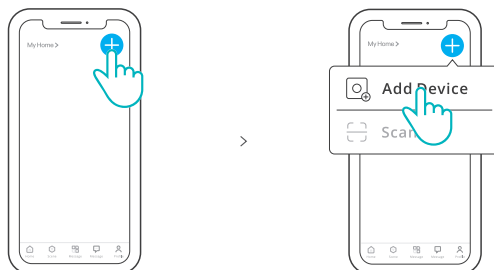

Tap "+" and select "Add Device", then operate following the prompt on the App.

Compatible Pairing Mode

If you fail to enter Quick Pairing Mode, please try "Compatible Pairing Mode" to pair.

- ① Press and hold the pairing button for 5s until the buzzer makes two short beeps and one long beep then release. Press the pairing button for 5s again until the buzzer makes a high frequency of beeps, which means the device has entered "compatible pairing mode".
- ② Tap "+" and select "Add Device" then select "Compatible Mode" on APP.
Select Wi-Fi SSID with ITEAD-***** and enter the password 12345678, and then go back to eWeLink APP and tap "Next". Be patient until pairing completes.
- ⓘ Keep turning the device on and off repeatedly for 5 times (on-off-on-off-on-off-on-off-on) to enter "compatible pairing mode".

Remove the Battery Insulation Sheet

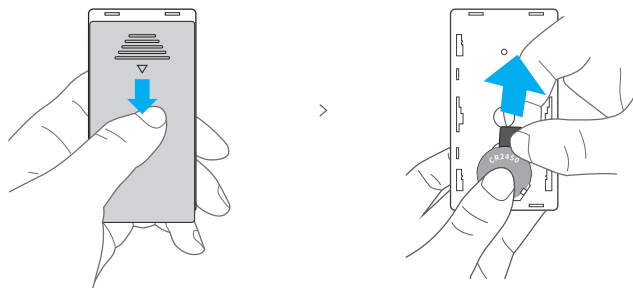

After factory setting, RM433R2 remote controller is bound to iFan04 by default. Simply remove the battery insulation sheet to use. If the device connected to iFan04 is not controlled by the remote controller, try to learn the remote controller again.

Learning Method for iFan04 and RM433R2 Remote Controller

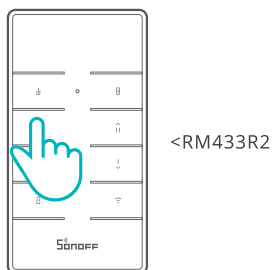

After powering on iFan04, press any button on the controller until the buzzer makes a "beep" sound within 5s, then all the buttons are learned successfully. If you do not operate any step within 5s, power the device on again and repeat the above operation.

⚠ This device can learn up to 10 remote controllers. The 11th remote controller will automatically cover the first learned one, and so on.

Specifications

Model	iFan04-L, iFan04-H
Input	100-240V~ 50/60Hz 5A Max
Output	<p>iFan04-L: Light: 100-240V~ 50/60Hz 3A Max Tungsten lamp: 360W/120V Max LED: 150W/120V Max Fan: 100-240V~ 50/60Hz 2A Max</p> <p>iFan04-H: Light: 100-240V~ 50/60Hz 3A Max Tungsten lamp: 690W/230V Max LED: 300W/230V Max Fan: 100-240V~ 50/60Hz 2A Max</p>
RF	433.92MHz (Receive only)
Wi-Fi	IEEE 802.11 b/g/n 2.4GHz
App operating systems	Android & iOS
Working temperature	-10°C~40°C
Material	PC V0
Dimension	116x55x26mm

Switch Network

Select the "Wi-Fi Settings" in the "Device Settings" interface on the eWeLink App to change.

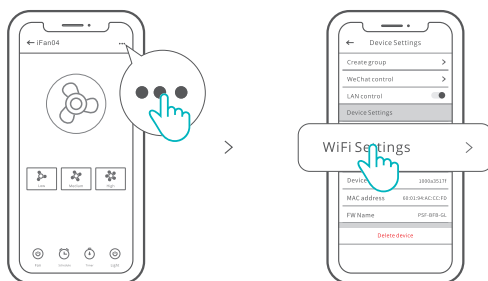

Re-establish Pairing

Method 1:

Press the "pairing button" on the device for 5s until the buzzer makes two short beeps and one long beep then release, which means the device has entered quick pairing mode, so it can be added in the eWeLink App again.

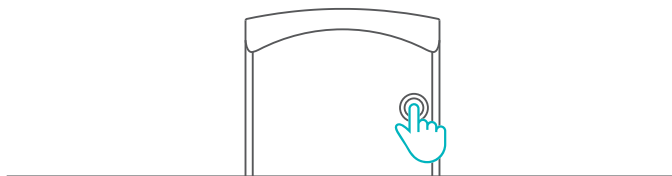

Method 2:

Press the "pairing button" on RM433R2 remote controller for 5s until the buzzer makes two short beeps and one long beep then release, which means the device has entered quick pairing mode, so it can be added in the eWeLink App again.



Method 3:

Keep turning the device on and off repeatedly for 3 times (on-off-on-off-on) until the buzzer makes two short beeps and one long beep then release, which means the device has entered quick pairing mode, so it can be added in the eWeLink App again.

⚠ In quick pairing mode, press any button on the remote controller to exit the current mode.

Factory Reset

Deleting the device on the eWeLink APP indicates you restore it to factory setting.

Remote Controller Specifications

Model	RM433R2
RF	433.92MHz
Remote controller size	87x45x12mm
Remote controller base size	86x86x15mm (not included)
Power supply	3V button cell x 1 (Battery model: CR2450)
Material	PC V0

Remote Controller Introduction

iFan04 can be controlled by RM433R2 remote controller. After learning is successful, you can control the device connected with iFan04 according to the button instruction below. This feature is referred to as a short-distance wireless communication, unrelated to Wi-Fi network communication.

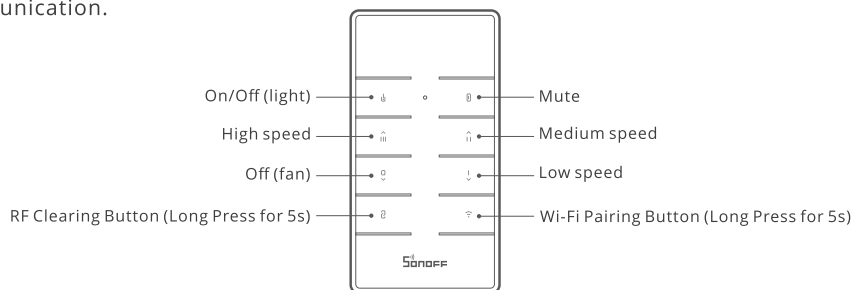

RF Clearing Method:

Press and hold the RF clearing button for 5s the buzzer makes "beep, beep" sound after clearing is successful.

The buzzer of iFan04 in factory default setting will indicate you with the "beep" sound when you turn on/off the fan, adjust the fan speed, and the device enters pairing mode, but no a "beep" sound is made when you turn on/off the light. You can press the "Mute" button on the paired RM433R2 remote controller to silence the buzzer.

Common Problems

Fail to pair Wi-Fi devices to eWeLink APP

1. Make sure the device is in pairing mode. After three minutes of unsuccessful pairing, the device will automatically exit pairing mode.
2. Please turn on location services and allow location permission. Before choosing the Wi-Fi network, location services should be turned on and location permission should be allowed. Location information permission is used to obtain Wi-Fi list information. If you click Disable, you will not be able to add devices.
3. Make sure your Wi-Fi network runs on the 2.4GHz band.
4. Make sure you entered a correct Wi-Fi SSID and password, no special characters contained. Wrong password is a very common reason for pairing failure.
5. The device shall get close to the router for a good transmission signal condition while pairing.

FCC compliance statement

1.This device complies with part 15 of the FCC Rules. Operation is subject to the following two conditions:

(1) This device may not cause harmful interference, and

(2) This device must accept any interference received, includinginterference that may cause undesired operation.

2.Changes or modifications not expressly approved by the

party responsible for compliance could void the user's authority to operate the equipment.

Note: This equipment has been tested and found to comply with the limits for a Class B digital device, pursuant to part 15 of the FCC Rules. These limits are designed to provide reasonable protection against harmful interference in a

residential installation. This equipment generates, uses and can radiate radio frequency energy and, if not installed and used in accordance with the instructions, may cause harmful interference to radio communications. However, there is no guarantee that interference will not occur in a particular installation. If this equipment does cause harmful interference to radio or television reception, which can be determined by turning the equipment off and on, the user is encouraged to try to correct the interference by one or more of the following measures:

—Reorient or relocate the receiving antenna.

—Increase the separation between the equipment and receiver.

—Connect the equipment into an outlet on a circuit different from that to which the receiver is connected.

—Consult the dealer or an experienced radio/TV technician for help.

FCC Radiation Exposure statement:

This equipment complies with FCC radiation exposure limits set forth for an uncontrolled environment.

This equipment should be installed and operated with minimum distance of 20 cm between the radiator and your body.

This transmitter must not be co-located or operating in conjunction with any other antenna or transmitter.

Scatola	Manuale
PAP 21	PAP 22
Carta	Carta
RACCOLTA	
Verifica le disposizioni del tuo Comune. Separa le componenti e conferiscile in modo corretto.	

ISED Notice

This device contains licence-exempt transmitter(s)/receiver(s) that comply with Innovation, Science and Economic Development Canada's licence-exempt RSS(s). Operation is subject to the following two conditions:

(1) This device may not cause interference.

(2) This device must accept any interference, including interference that may cause undesired operation of the device.

This Class B digital apparatus complies with Canadian ICES-003(B).

This device complies with RSS-247 of Industry Canada.

Operation is subject to the condition that this device does not cause harmful interference.

L'émetteur/récepteur exempt de licence contenu dans le présent appareil est conforme aux CNR d'Innovation, Sciences et Développement économique Canada applicables aux appareils radio exempts de licence. L'exploitation est autorisée aux deux conditions suivantes :

(1) L'appareil ne doit pas produire de brouillage;

(2) L'appareil doit accepter tout brouillage radioélectrique subi, même si le brouillage est susceptible d'en compromettre le fonctionnement.

Cet appareil numérique de la Classe B conforme à la norme NMB-003(B) du Canada.

Cet appareil est conforme à la norme RSS - 247 d'Industrie

Canada. Le fonctionnement est soumis à la condition que cet appareil ne provoque pas d'interférences nuisibles.

ISED Radiation Exposure Statement

This equipment complies with ISED radiation exposure limits set forth for an uncontrolled environment.

This equipment should be installed and operated with minimum distance of 20 cm between the radiator and your body.

This transmitter must not be co-located or operating in conjunction with any other antenna or transmitter.

Cet équipement est conforme aux limites d'exposition aux rayonnements de la ISED établies pour un environnement non contrôlé.

Cet équipement doit être installé et fonctionner à au moins 20cm de distance d'un radiateur ou de votre corps.

Cet émetteur ne doit pas être co-localisé ou fonctionner en conjonction avec une autre antenne ou un autre émetteur.

SAR Warning

Under normal use of condition, this equipment should be kept a separation distance of at least 20 cm between the antenna and the body of the user.

Dans des conditions normales d'utilisation, cet équipement doit être maintenu à une distance d'au moins 20 cm entre l'antenne et le corps de l'utilisateur.

EU Declaration of Conformity

Hereby, Shenzhen Sonoff Technologies Co., Ltd. declares that the radio equipment type iFan04-L, iFan04-H, RM433R2 is in compliance with Directive 2014/53/EU. The full text of the EU declaration of conformity is available at the following internet address: <https://sonoff.tech/compliance/>.



WARNING!

Do not ingest battery, Chemical Burn Hazard.

This product contains a coin / button cell battery. If the coin / button cell battery is swallowed, it can cause severe internal burns in just 2 hours and can lead to death.

Keep new and used batteries away from children.

If the battery compartment does not close securely, stop using the product and keep it away from children. If you think batteries might have been swallowed or placed inside any part of the body, seek immediate medical attention.

Do not replace a battery with an incorrect type.

Disposal of a battery into fire or a hot oven, or mechanically crushing or cutting of a battery, that can result in an explosion.

Leaving a battery in an extremely high temperature surrounding environment that can result in an explosion or the leakage of flammable liquid or gas.

A battery subjected to extremely low air pressure that may result in an explosion or the leakage of flammable liquid or gas.

For CE Frequency

EU Operating Frequency Range:

iFan-04H, iIFan-04L

Wi-Fi: 802.11 b/g/n 2412-2472 MHz

433.92MHz (Receive Only)

EU Output Power:

Wi-Fi 2.4G ≤ 20dBm

RM433R2

SRD: 433.92MHz

433.92MHz ≤ 10dBm

WEEE Disposal and Recycling Information



All products bearing this symbol are waste electrical and electronic equipment (WEEE as in directive 2012/19/EU) which should not be mixed with unsorted household waste. Instead, you should protect human health and the environment by handing over your waste equipment to a designated collection point for the recycling of waste electrical and electronic equipment, appointed by the government or local authorities. Correct disposal and recycling will help prevent potential negative consequences to the environment and human health. Please contact the installer or local authorities for more information about the location as well as terms and conditions of such collection points.



Shenzhen Sonoff Technologies Co., Ltd.

1001, BLDG8, Lianhua Industrial Park, shenzhen, GD, China

ZIP code: 518000

Website: sonoff.tech

Service email: support@itead.cc

MADE IN CHINA

